

zipato®

DOOR/WINDOW SENSOR

QUICK INSTALLATION GUIDE
v1.0



www.zipato.com

INTRODUCTION

Thanks for choosing the Zipato's wireless door sensor to increase your home security. This sensor is a Z-Wave enabled device (interoperable, two-way RF mesh networking technology) and is fully compatible with any Z-Wave enabled network. Every mains powered Z-Wave enabled device acts as a signal repeater and multiple devices result in more possible transmission routes which helps eliminate "RF dead-spots". Like all Z-Wave devices displaying the Z-Wave logo, Zipato Door Sensor can also be used with various Z-Wave networks and controllers, regardless of the manufacturer. This sensor monitors door and send Z-Wave signal when door is opened and closed. This product is a security enabled Z-Wave product that is able to use encrypted Z-Wave messages to communicate to other security enabled Z-Wave products. A security enabled Z-Wave controller should be used in order to fully utilize the product.

Door sensor is an intelligent security equipment that can transmit through Z-Wave network and radio waves. In the Z-Wave network communications, door sensor can be connected to any Z-Wave gateway. Door sensor can send messages to Z-Wave gateway, then realize association with other devices. Different countries or areas, the radio frequency is different.

Each door sensor has a unique ID code. When we add or remove door sensor from gateway, just place it in the Z-Wave network range of gateway. Then we can easily find the door sensor through device ID code. In the communication with Z-Wave gateway, door sensor can only send messages to Z-Wave gateway, but can not receive messages. When alarm is triggered, door sensor would send messages to gateway, then Z-Wave gateway would display the current status of door sensor. At the same time, door sensor can realize association with other devices through Z-Wave gateway. Door sensor is powered by batteries, with small body, and can be

1.

installed on the window or door easily. When door or window is open, door sensor would be triggered, then associates with other devices to work, to realize the goal of safety protection.

SPECIFICATION

Protocol: Z-Wave Plus
Power: CR2-3Vx1
Standby Current: 1uA
Operating Temperature: 0°C ~ 40°C
Storage Temperature: 0°C ~ 60°C
Range: Up to 60m outdoor, up to 30m indoor
Radio Frequency: 3868.4MHz EU; 908.4MHz US; 921.4MHz ANZ; 869.2MHz RU
Battery Life: 1 year

MODELS AND FREQUENCIES

Australia	ne-nas-ds01z.au / 919.80 MHz , 921.40MHz
European Union	ne-nas-ds01z.eu / 868.40 MHz, 869.85 MHz
India	ne-nas-ds01z.in / 865.20MHz
Israel	ne-nas-ds01z.is / 916.00 MHz
Russia	ne-nas-ds01z.ru / 869.00 MHz
United States	ne-nas-ds01z.us / 908.40 MHz, 916.00 MHz

TECHNICAL INFORMATION

- Installed on the door or window
- Battery powered
- Easily installed with screws or sticker

2.

- Associate with other devices through gateway
- Compatible with any Z-Wave network

PRODUCT CONFIGURATION

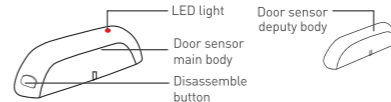

PACKAGE CONTENT

Doorsensor main body	1 pc
Doorsensor deputy body	1 pc
Battery	1 pcs
Screw	4pcs
Screw stopper	4pcs
Sticker	2pcs
Usermanual	1 pc

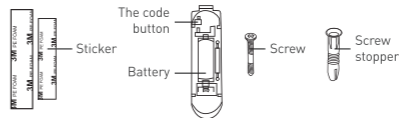

3.

INSTALLATION STEPS

Door sensor Installation

Option One

Disassemble the door sensor main body and take out battery, fix the main body on the door with screws. Disassemble the door sensor deputy body and fix it on the corresponding doorframe position.

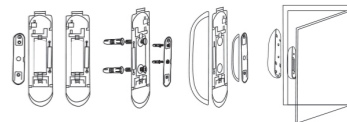

Option Two

Put the sticker on the bottom of door sensor then fix it on the wall.



NOTE: When installing door sensor, door sensor deputy body must be installed on the bulge side of the door sensor main body.

4.

BATTERY INSTALLATION



Disassemble the door sensor main body

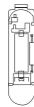

Install the battery



Assemble the door sensor main body

TIPS

1. When installing door sensor, the distance between main body and deputy body should be less than 2 cm in the state of door closed.
2. When door is closed, that is to say, distance between main body of door sensor and deputy body is less than 2 cm, app would display door is closed.
3. When door is opened, that is to say, distance between main body of door sensor and deputy body is more than 2 cm, the app would display the door is opened. Through gateway, door sensor can associate with IP camera to take pictures and record video, siren to alarm.
4. Make sure door sensor is placed in the Z-Wave network range of gateway.

BATTERY USAGE TIPS

Battery life of door sensor is approximately 1 year. The power level of battery would be displayed in the gateway. Red icon means the battery needs replacing, and then mobile app would receive a message "power level is low, please remember to replace battery" from gateway. In order to avoid false alarm, before replacing battery, please disconnect association of door sensor with other devices.

5.

NOTE: Door sensor is powered by battery, and please use battery in a correct way to avoid exploding. When handling the battery, refer to environmental law please.

THE STATUS OF LED

1. When door sensor is triggered, LED lights would flash red color 1 time.
2. When door sensor is installed with battery, LED lights would flash red color 5 times.
3. Add or remove door sensor from Z-Wave network by quickly pressing the button 3 times, then LED lights would flash red color 5 times.
4. Press and hold the code button for 10-15 s, then door sensor would be restored to factory default settings. Meanwhile, LED lights would flash red color 5 times on and off alternately.
5. Under the normal state, LED lights would keep "off" state.

ADD DOOR SENSOR TO Z-WAVE NETWORK

- Door sensor can be included to Z-Wave network by pressing the code button.
- 1) Disassemble the main body of door sensor by pressing the disassemble button, then install battery. After making it powered on, please do not operate it within 20 s.
 - 2) Place door sensor within Z-Wave network range of gateway.
 - 3) Set Z-Wave gateway into inclusion mode [Refer to gateway user manual].
 - 4) Press the code button in door sensor three times continuously, then door sensor will enter inclusion mode. Meanwhile, LED light would flash red color five times on and off alternately.
 - 5) Door sensor will be detected and included in the Z-Wave network.
 - 6) Wait for gateway to configure the sensor.

6.

REMOVE DOOR SENSOR FROM Z-WAVE NETWORK

- 1) Make sure doorsensor is powered on.
- 2) Set Z-Wave gateway into exclusion mode [Refer to gateway user manual].
- 3) Press the code button in door sensor three times continuously, then door sensor will enter exclusion mode. Meanwhile, LED light would flash red color five times on and off alternately.
- 4) Wait for gateway to remove the sensor.

RESTORE DOOR SENSOR TO FACTORY DEFAULT SETTINGS

- Reset procedure will delete all information in the Z-wave network or Z-Wave gateway, and will restore door sensor to factory default settings.
1. Remove the cover of door sensor main body.
 2. Make sure the sensor is powered.
 3. Press and hold the reset button for 10-15 seconds, then LED lights would flash red color 5 times on and off alternately.
 4. Release the button.
- NOTE: During the process of resetting, please make sure door sensor is powered on all the time.

ASSOCIATIONS

[Association Command Class Version 2]
This Sensor supports 4 association groups. Every group can be supported to associate 5 devices max. This has the effect that when the sensor is triggered, all devices associated with it will receive relevant reports. Through association, door sensor can control another Z-Wave network device, e.g. a alarm device, wall plug, Lamp etc.

GROUP 1 is lifeline service that assigned to Sensor [Door/Window detector] status -

7.

Open/Close. It enables the sensor to send reports and readings to Z-Wave Gateway whenever the sensor is triggered.

This Group Support:
NOTIFICATION_REPORT
BATTERY_REPORT
SENSOR_BINARY_REPORT
DEVICE_RESET_LOCALLY_NOTIFICATION

GROUP 2 allows sending control commands to associated devices such as relay module, lighting, etc. This association group is configured through the advanced parameters no. 1 and 2. This Group Support: BASIC_SET.

GROUP 3 allows Sending Notification to associated devices in this group. This Group Support: NOTIFICATION_REPORT

GROUP 4 allows for Send Notification to associated devices in this group. This Group Support: SENSOR_BINARY_REPORT

ADVANCED CONFIGURATION

1. Configuring the OFF Delay

This configuration parameter can be used to adjust the amount of delay before the OFF command is transmitted. This parameter can be configured with the value of 0 through 65535, where 0 means send OFF command immediately and 65535 means 65535 seconds of delay.

Function: On/Off Duration.
Parameter Number: 1.

8.

ParameterSize: 2 Byte
AvailableSettings: 0-65535 (in seconds, each 1s).
DefaultSetting: 0 (s)

2. Basic Set Level

Basic Set Command will be sent where contains a value when the door/window is opened or closed, Z-Wave controller or Z-Wave gateway will take it for consideration; for instance, if a lamp module receives the Basic Set Command of which value is decisive as to how bright or dim level of lamp modules shall be.

Function: Basic Set

Parameter Number: 2

Parameter Size: 1 Byte

Available Settings: 0, 1 - 99 or 255.0 - OFF, Alarm cancelling or turning a device off; 1 - 99 or 255 - ON (Binary Switch Device); Dim Level (Multilevel Switch Device)
Default Setting: 255

Notification Command Class

Once the detector detects the magnet of sensor is to be opened, it will send NOTIFICATION_REPORT and SENSOR_BINARY_REPORT to the nodes of lifeline to inform there is an intrusion event. When the magnet is to be closed, NOTIFICATION_REPORT and SENSOR_BINARY_REPORT will be sent again to the nodes in lifeline.
For compliant to Z-Wave 300 Series, there also realize the Binary Sensor Command Class.

Notification Report Command:

Event Present:

Command Class: COMMAND_CLASS_NOTIFICATION

9.

Command: NOTIFICATION_REPORT
NotificationType: NOTIFICATION TYPE ACCESS_CONTROL3
Event: NOTIFICATION_EVENT ACCESS_CONTROL WINDOW
_OR_DOORIS_OPENED
Event Clear:
Command Class: COMMAND_CLASS_NOTIFICATION,
Command: NOTIFICATION_REPORT
NotificationType: NOTIFICATION TYPE ACCESS_CONTROL
Event: NOTIFICATION_EVENT ACCESS_CONTROL WINDOW _OR_DOOR_IS_-
CLOSED

Binary Sensor Report Command:

Event Present:
Command Class: COMMAND_CLASS_SENSOR_BINARY
Command: SENSOR_BINARY_REPORT
Sensor Type: SENSOR_DOOR_WINDOW
Value:0xFF
Event Clear:
Command Class: COMMAND_CLASS_SENSOR_BINARY
Command: SENSOR_BINARY_REPORT
Sensor Type: SENSOR_DOOR_WINDOW
Value: 0x00

Wakeup Command Class

Door sensor stays in dormant state for the majority of time in order to conserve battery life.
The minimum wakeup interval is 300s (5 minutes).
The maximum wakeup interval is 16,777,200s (about 194 days)
Allowable min step among each wakeup interval is 60 seconds, such as 360s,

420s, 480s...

NOTE: The default value is 12 hours. The larger the value is, the greater the battery life is.

Battery Check Command

Users can also enquire the battery status of door sensor by sending BATTERY GET command. Once door sensor receives the command, it will return BATTERY REPORT command. Door sensor would send BATTERY LEVEL = 0xFF command to Z-Wave gateway to inform that door sensor is in dead battery status, otherwise BATTERY LEVEL value range is 0% to 100%.

COMMAND CLASSES

This Sensor (Door/Windows Detector) supports Command Classes as Below:
*COMMAND_CLASS_ZWAVEPLUSINFO (V2)
*COMMAND_CLASS_VERSION (V2)
*COMMAND_CLASS_MANUFACTURER_SPECIFIC (V2)
*COMMAND_CLASS_DEVICE_RESET_LOCALLY (V1)
*COMMAND_CLASS_POWERLEVEL (V1)
*COMMAND_CLASS_BATTERY (V1)
*COMMAND_CLASS_ASSOCIATION (V2)
*COMMAND_CLASS_ASSOCIATION_GRP_INFO (V1)
*COMMAND_CLASS_WAKE_UP (V2)
*COMMAND_CLASS_NOTIFICATION (V4)
*COMMAND_CLASS_SENSOR_BINARY (V2)
*COMMAND_CLASS_CONFIGURATION (V1)

LIMITED PRODUCT WARRANTY

GENERAL TERMS

Nothing in this Limited Product Warranty affects your statutory rights as a consumer. The Limited Product Warranty set forth below is given by Tri plus grupa d.o.o. (Europe) (herein referred to as "ZIPATO"). This Limited Product Warranty is only effective upon presentation of the proof of purchase. Upon further request by ZIPATO, this warranty card has to be presented, too.

EXCEPT AS EXPRESSLY SET FORTH IN THIS LIMITED WARRANTY, ZIPATO MAKES NO OTHER WARRANTIES, EXPRESS OR IMPLIED, INCLUDING ANY IMPLIED WARRANTIES OF MERCHANTABILITY AND FITNESS FOR A PARTICULAR PURPOSE. ZIPATO EXPRESSLY DISCLAIMS ALL WARRANTIES NOT STATED IN THIS LIMITED WARRANTY. ANY IMPLIED WARRANTIES THAT MAY BE IMPOSED BY LAW ARE LIMITED IN DURATION TO THE LIMITED WARRANTY PERIOD. TO THE EXTENT ALLOWED BY LOCAL LAW, THE REMEDIES IN THIS WARRANTY STATEMENT ARE CUSTOMER'S SOLE AND EXCLUSIVE REMEDIES AGAINST ZIPATO. THEY DO NOT, HOWEVER, AFFECT OR RESTRICT THE RIGHTS YOU HAVE AGAINST THE BUSINESS YOU BOUGHT A ZIPATO PRODUCT FROM. IN NO EVENT WILL ZIPATO BE LIABLE FOR LOSS OF DATA OR FOR INDIRECT, SPECIAL, INCIDENTAL, CONSEQUENTIAL (INCLUDING LOST PROFIT OR DATA), OR OTHER DAMAGE, WHETHER BASED IN CONTRACT, TORT, OR OTHERWISE. HOWEVER, NOTHING IN THIS AGREEMENT LIMITS ZIPATO'S LIABILITY TO YOU (I) IN THE EVENT OF DEATH OR PERSONAL INJURY TO THE EXTENT RESULTING FROM ZIPATO'S NEGLIGENCE, OR (II) TO THE EXTENT RESULTING FROM ANY FRAUDULENT MISREPRESENTATION ON THE PART OF ZIPATO, OR (III) TO THE EXTENT ARISING UNDER PART 1 OF THE CONSUMER PROTECTION ACT 1987 OF THE UNITED KINGDOM. SOME STATES OR COUNTRIES DO NOT ALLOW: (1) A DISCLAIMER OF IMPLIED WARRANTIES; (2) A LIMITATION ON HOW LONG AN

IMPLIED WARRANTY LASTS OR THE EXCLUSION; OR (3) LIMITATION OF INCIDENTAL OR CONSEQUENTIAL DAMAGES FOR CONSUMER PRODUCTS. IN SUCH STATES OR COUNTRIES, SOME EXCLUSIONS OR LIMITATIONS OF THIS LIMITED WARRANTY MAY NOT APPLY TO YOU. THIS LIMITED WARRANTY GIVES YOU SPECIFIC LEGAL RIGHTS. YOU MAY ALSO HAVE OTHER RIGHTS THAT MAY VARY FROM STATE TO STATE OR FROM COUNTRY TO COUNTRY. YOU ARE ADVISED TO CONSULT APPLICABLE STATE OR COUNTRY LAWS FOR A FULL DETERMINATION OF YOUR RIGHTS.

This Limited Product Warranty applies to ZIPATO branded hardware products (collectively referred to as "ZIPATO Hardware Products") sold by ZIPATO (Europe), its European subsidiaries, affiliates, authorized resellers, or country distributors (collectively referred to as "ZIPATO Resellers") with this Limited Product Warranty.

The term "ZIPATO Hardware Product" is limited to the hardware components and all its internal components including firmware.
The term "ZIPATO Hardware Product" DOES NOT include any software applications or programs.

GEOGRAPHICAL SCOPE OF THE LIMITED PRODUCT WARRANTY

This Limited Product Warranty is applicable to Hardware Products sold by Zipato Resellers in all countries listed at the beginning of this document under the heading "Countries in which this ZIPATO Limited Product Warranty applies". The Limited Product Warranty will be honored in any country where ZIPATO or its authorized service providers offer warranty service subject to the terms and conditions set forth in this Limited Product Warranty. However, warranty service availability and response times may vary from country to country and may also be subject to registration requirements.

LIMITATION OF PRODUCT WARRANTY

ZIPATO warrants that the products described below under normal use are free from material defects in materials and workmanship during the Limited Product Warranty Period set forth below ("Limited Product Warranty Period"), if the product is used and serviced in accordance with the user manual and other documentation provided to the purchaser at the time of purchase (or as amended from time to time).

ZIPATO does not warrant that the products will operate uninterrupted or error-free or that all deficiencies, errors, defects or non-conformities will be corrected. This warranty shall not apply to problems resulting from: (a) unauthorized alterations or attachments; (b) negligence, abuse or misuse, including failure to operate the product in accordance with specifications or interface requirements; (c) improper handling; (d) failure of goods or services not obtained from ZIPATO or not subject to a then-effective ZIPATO warranty or maintenance agreement; (e) improper use or storage; or (f) fire, water, acts of God or other catastrophic events. This warranty shall also not apply to any particular product if any ZIPATO serial number has been removed or defaced in any way.

ZIPATO IS NOT RESPONSIBLE FOR DAMAGE THAT OCCURS AS A RESULT OF YOUR FAILURE TO FOLLOW THE INSTRUCTIONS FOR THE ZIPATO HARDWARE PRODUCT.

LIMITED PRODUCT WARRANTY PERIOD

The Limited Product Warranty Period starts on the date of purchase from ZIPATO. Your dated sales or delivery receipt, showing the date of purchase of the product, is your proof of the purchase date. You may be required to provide proof of purchase as a condition of receiving warranty service. You are entitled to warranty service according to the terms and conditions of this document if a repair to your ZIPATO

branded hardware is required within the Limited Product Warranty Period.
[Other than in respect of products for domestic use (in particular those listed in the first and last boxes in the table below), this Limited Product Warranty extends only to the original end user purchaser of this ZIPATO Hardware Product and is not transferable to anyone who obtains ownership of the ZIPATO Hardware Product from the original end-user purchaser.

PRODUCT WARRANTY PERIOD

Product type: Multisensor motion, temperature, light

Product warranty period: One (1) year

IMPORTANT

The content of "Product Type" listed above is subject to change; please refer to the www.zipato.com for latest update.

PERFORMANCE OF THE LIMITED PRODUCT WARRANTY

If a product defect occurs, ZIPATO's sole obligation shall be to repair or replace any defective Zipato Hardware Product free of charge provided it is returned to an Authorized ZIPATO Service Centre during the Limited Warranty Period. Such repair or replacement will be rendered by ZIPATO at an Authorized ZIPATO Service Centre. All component parts or hardware products that are replaced under this Limited Product Warranty become the property of ZIPATO. The replacement part or product takes on the remaining Limited Warranty Period of the replaced part or product. The replacement product need not be new or of an identical make, model or part; ZIPATO may in its discretion replace the defective product (or any part thereof) with any reconditioned equivalent (or superior) product in all material respects to the defective product.

WARRANTOR
Tri plus grupa d.o.o.
Banjaveciceva 11
10 000 Zagreb
CROATIA
TEL +385 (0)1 4004 404
Fax +385 (0)1 4004 405

DECLARATION OF CONFORMITY



FCC in compliance with Part 15 Low Power Transceiver, Rx Verified

The manufacturer Tri plus grupa d.o.o. declares under our sole responsibility that this product is in conformity with the RED directive 2014/53/EU.
Marketing model: Door/Widow Sensor, Z-Wave
Trade/Brand name: Zipato

The following standards were applied:

ETSI EN 300 220-1 V3.1.1(2017-02)
ETSI EN 300 220-2 V3.1.1(2017-02)
ETSI EN 301 489-1 V2.2.0 (2017-03)
ETSI EN 301 489-3 V3.2.0 (2017-03)
EN 62479:2010
EN 60950-1:2006+A11:2009+A1:2010+A12:2011+A2:2013

Changes or modifications not expressly approved by Tri plus grupa d.o.o. for compliance could void the user's authority to operate the equipment.

DISPOSING AND RECYCLING YOUR PRODUCT

When it reaches end of life, dispose of the product according to your local environmental laws, guidelines and regulations.



This symbol on the product or packaging means that according to local laws and regulations needs to be disposed of separately from household waste. Once this product has reached the end of its life, please take it to a collection point (recycle facilities) designated by your local authorities, some will accept your product for free or simply drop it off at your Zipato re-seller store. By recycling the product and its packaging in this manner you help to conserve the environment and protect human health. At Zipato, we understand and are committed to reducing any impact our operations and products may have on the environment. To minimize this impact Zipato designs and builds its products to be as environmentally friendly as possible, by using recyclable, low toxic materials in both products and packaging.

COPYRIGHT

© 2017 Tri plus grupa d.o.o. All Rights Reserved.
No part of this manual may be reproduced or transmitted in any form without the expressed, written permission of Tri plus grupa d.o.o.